

Angular Contact Ball Bearings

Brass cage angular contact ball bearing-7314 BECBPH

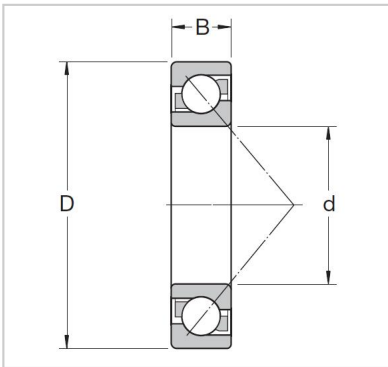

Abutment and fillet dimensions

Db max.	7314 BECBPH
Da max.	-
da min.	70
rb max.	150
ra max.	35

Dimensions

a	127
r3,4 min.	98
r1,2 min	3.9
D1	5 600
d2	5 600
d1	2.65

Mass

KG	101
----	-----

Speed ratings r/min

Limiting speed	84.4
----------------	------

Reference speed	121
-----------------	-----

Fatigue load limit

Pu kN	2.1
-------	-----

Basic load ratings KN

dynamic C kN	1.1
--------------	-----

static Co kN	64
--------------	----

Basic design bearing

B mm	82
------	----

D mm	138
------	-----

d mm	143
------	-----

Basic design bearing	2
----------------------	---

Designations

Universally matchable bearing	1
-------------------------------	----------